



PA32DC Firmware Update Procedures



When there is a newer version of firmware available on the ASUS website, follow the procedures below to update your monitor. Make sure that the power supply is stable and the USB drive is plugged in during the whole process.

1. Download and extract the latest firmware file to the root directory of a USB 2.0 drive (File system: FAT32). The monitor can only be upgraded using firmware file named **“PA32DC.bin” (for scaler)** and **“binfname.txt” & “PA32DC_M.bin” (for MCU)**.

Name	Date modified	Type	Size
 PA32DC.bin	9/23/2022 12:07 PM	BIN File	1,800 KB

Name	Date modified	Type	Size
 PA32DC_M.bin	9/26/2022 5:59 PM	BIN File	76 KB
 binfname.txt	9/26/2022 5:59 PM	Text Document	1 KB

2. Insert USB drive into the **USB 3.2 Type-A** port at the back of the monitor. Please use the **bottom** USB port which supports FW upgrade.

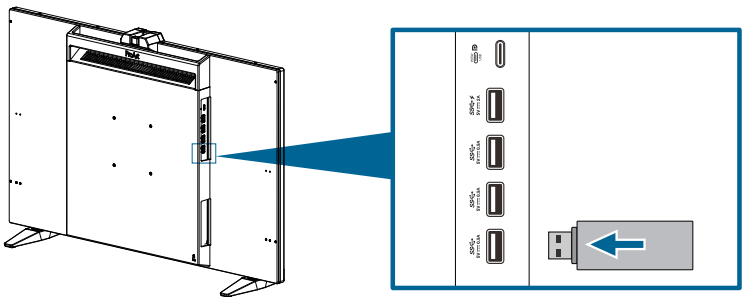

3. Two ways for updating firmware

- a. Press the second and the fourth buttons counted from right simultaneously.
The monitor will begin the firmware update which takes about 25 seconds.

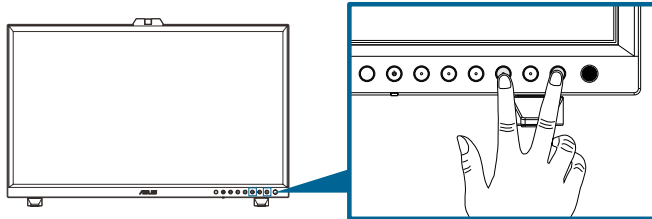

- b. Press the two buttons counted from the right of power key simultaneously.
The monitor will begin the firmware update which takes about 25 seconds.

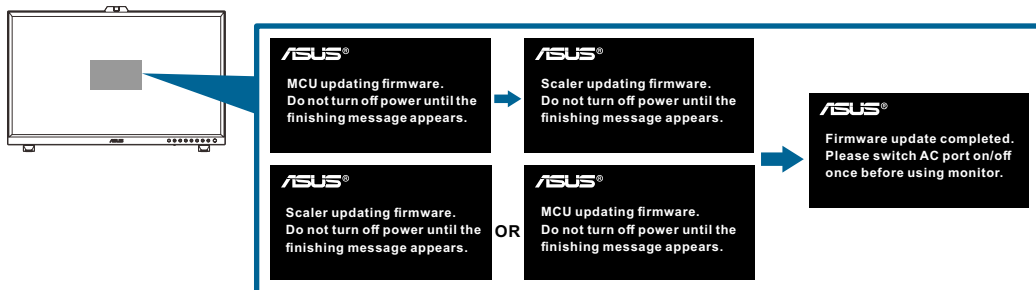
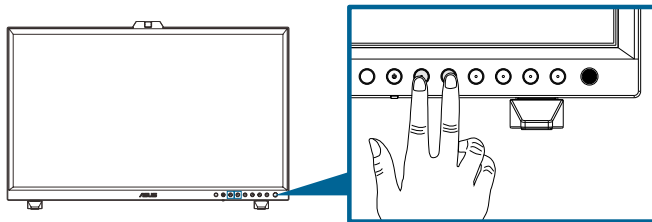

If you have a power failure during the process, the monitor will turn off and be restored to original factory firmware.

After power resumes, the monitor will reboot. Perform step 3 again to resume firmware update. Contact your local service center if you encounter any problems.

4. After the firmware update completes, switch off and then on the monitor using the power switch on the back.

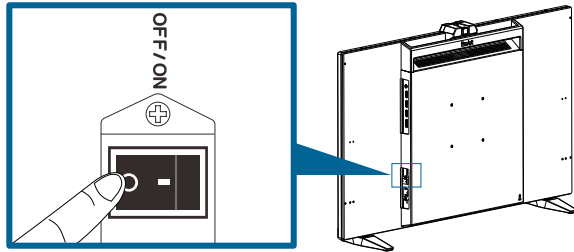

It might take a few cycles for the firmware update process to complete. Follow the OSD messages and reboot the monitor using the power switch on the back after the process is completed.

5. Turn on the monitor and reset all settings via the System Setup menu. The OSD menu settings will be restored to factory defaults. Check the firmware version in the System Setup > Information menu.

